

Copy of deed from Martha Hill to Jas. S. Johnson, dated
 8th Dec^r 1883, not recd. Part N.W. 1/4 3 T 5 N R 1 W, Beg 26.35 ch W
 from N.E. cor. S 68° E, 4.62 ch, S. 45 ch, W. 5.75 ch, N. 2.30 ch E.
 1.50 on Sec line to log: 93 or reserving a right of way 10 ft
 wide on N. side

John D. Mealan to John Wilson - March 7 - 1878 - L-309 - Part of
 N.W. 1/4 3 T 5 N R 1 W, Beg 8.75 ch S. N.W. cor. S. 5.10 N 52 1/2 E 6.6
 5.24 E 2.90 E. 10.12 N. 10.30 W. 14.15 ch, S 24 E 6.75 S 52 1/2 W

to the place of log. 14.65 a

John Wilson to Jas. T. Johnson, Pl. N.W. 1/4 3 4 pt N.E. 1/4 4 T 5 N
 Beg. 8.75 ch S. from N.W. cor 3 S 52 1/4 W 10-65 ch, S 48 E 4.20
 N 52 1/2 E 12.90 S 24 E 2.90 E 10.14 N 10.30 W. 14.15 S 22 E
 3.56 ch, S 52 1/4 W, to log 18 1/100 a (Q 314)

log 1° 18'	8.355793	
6.75	89-22	89-20
3.18	70	70
2.76.7	179 22	179 20
	130	150
	38	40
log sin 0° 38'	8.043501	
	1.956499	
sin 39° 22'	7.999973	
log 2.76.7	0.442323	
2.5049	2.398795	
	398634	
	173 1510/9	
log 0° 40'	8.065776	
0	1.934224	
log sin 39° 20'	7.999971	
log 3.13'	0.502564	
2.73.0	2.436759	
2.50.49		
52.3.89		
2.61.4		
37-22		
62-38		
00 00		

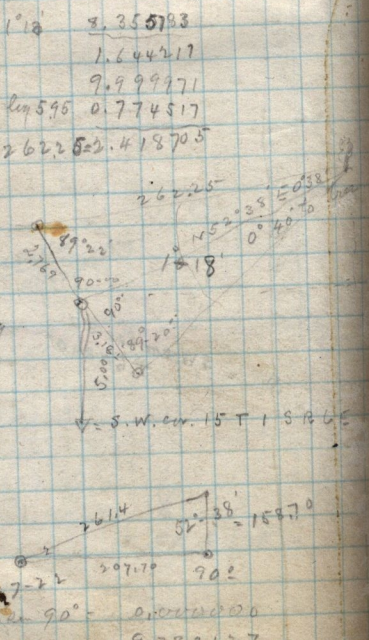

log sin 90° = 0.0000000
 9.783127
 2.417306
 1.204853